

**Technical details**

<b>Connection</b>	M5
<b>Temperature range</b>	-10°C ... +70°C
<b>Medium</b>	Filtered, oil-free and dried compressed air according to ISO 8573-1:2010, Class 7:2:4, instrument air, free of aggressive additives. Differing the pressure dew point must be at least 10°C below lowest occurring ambient temperature.
<b>Materials</b>	Body: Al (anodized), seals: NBR, inner parts: stainless steel and brass, stem: stainless steel
	Valves in accordance with 2014/34/EU (ATEX) available. (Chapter 13)

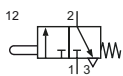

Mechanically operated seat valve (T-30-310) or spool valve (T-30-510) including mounting adapter for actuator mount.

**3/2-way-Valves**

**T-30-310**  
3/2-way, mechanical spring return, stem operated

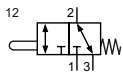

**T-30-310-ATEX**  
3/2-way, mechanical spring return, stem operated

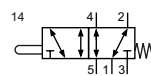
**5/2-way-Valves**

**T-30-510**  
5/2-way, mechanical spring return, stem operated

**Technical data**

Model-no.:	T-30-310	T-30-510
<b>Operating pressure (bar)</b>	0 ... 12	0 ... 12
<b>Flow rate (NI/min)</b>	80	100
<b>Nominal size (mm)</b>	2	2.4
<b>Actuating force at 6 bar (N)</b>	10	21
<b>Actuation stroke (mm)</b>	4	4
<b>Weight (kg)</b>	0.052	0.076

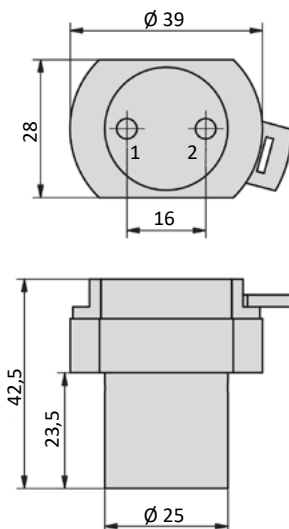
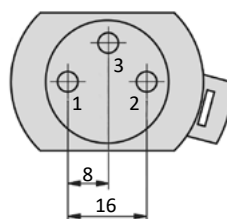
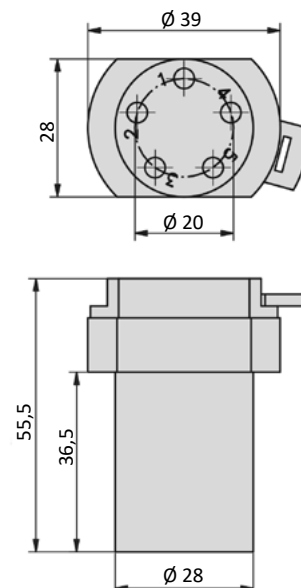
**Dimensions**
**T-30-310**

**T-30-310-ATEX**

**T-30-510**

- 1 = pressure inlet
- 2,4 = outlets
- 3,5 = exhausts

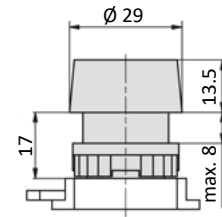
# Actuator $\varnothing$ 22.5 mm

## 18-T-23-011-xx Push button



Model-no.: 18-T-23-011-xx +	T-25-311	T-28-311	T-28-511	T-30-310	T-30-510
Symbol					
Actuating force at 6 bar (N)	24	23	15	13	23
Weight (with valve) (kg)	0.057	0.073	0.090	0.067	0.091

Please complete: xx = Color ( 20 = green, 21 = green with white line, 30 = black, 40 = red, 42 = red with white circle, 50 = yellow, 60 = blue )

## 18-T-23-012-xx Mushroom

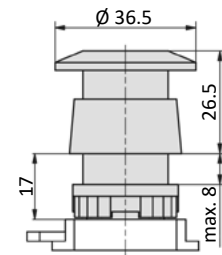

Model-no.: 18-T-23-012-xx +	T-25-311	T-28-311	T-28-511	T-30-310	T-30-510
Symbol					
Actuating force at 6 bar (N)	24	23	15	13	23
Weight (with valve) (kg)	0.062	0.078	0.095	0.072	0.096

Please complete: xx = Color ( 20 = green, 30 = black, 40 = red )

## 18-T-23-013 2 position switch

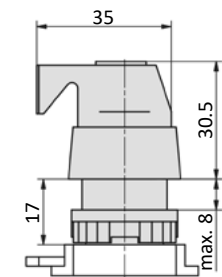

Model-no.: 18-T-23-013 +	T-25-311	T-28-311	T-28-511	T-30-310	T-30-510
Symbol					
Actuating force at 6 bar (N)	24	23	15	26	25
Weight (with valve) (kg)	0.064	0.080	0.097	0.074	0.098

# Actuator $\varnothing$ 22.5 mm

## 18-T-23-014 Key-return

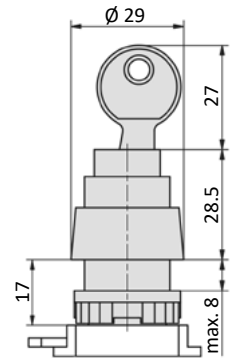

Model-no.: 18-T-23-014 +	T-25-311	T-28-311	T-28-511	T-30-310	T-30-510
Symbol					
Actuating force at 6 bar (N)	24	23	15	13	23
Weight (with valve) (kg)	0.123	0.139	0.156	0.133	0.157

## 18-T-23-015 Stop, key-return

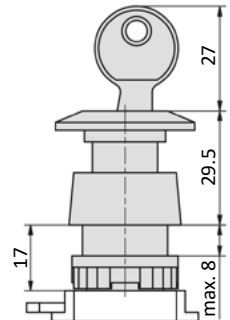

Model-no.: 18-T-23-015 +	T-25-311	T-28-311	T-28-511	T-30-310	T-30-510
Symbol					
Actuating force at 6 bar (N)	24	23	15	13	23
Weight (with valve) (kg)	0.125	0.141	0.158	0.135	0.159

## 18-T-23-016 Toggle

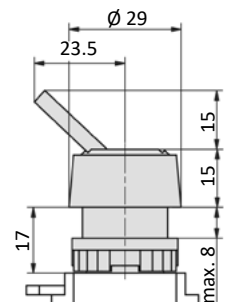

Model-no.: 18-T-23-016 +	T-25-311	T-28-311	T-28-511	T-30-310	T-30-510
Symbol					
Actuating force at 6 bar (N)	24	23	15	26	25
Weight (with valve) (kg)	0.069	0.085	0.102	0.079	0.103

# Actuator Ø 30 mm

## 18-T-30-011-xx Push button

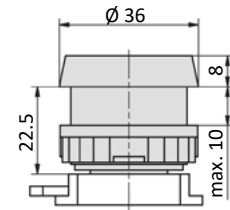

Model-no.: 18-T-30-011-xx +	T-25-311	T-28-311	T-28-511	T-30-310	T-30-510
Symbol					
Actuating force at 6 bar (N)	24	23	15	15	24
Weight (with valve) (kg)	0.066	0.082	0.099	0.076	0.100

Please complete: xx = Color ( 20 = green, 30 = black, 40 = red, 50 = yellow )

## 18-T-30-012-xx Mushroom

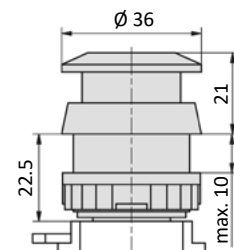

Model-no.: 18-T-30-012-xx +	T-25-311	T-28-311	T-28-511	T-30-310	T-30-510
Symbol					
Actuating force at 6 bar (N)	24	23	15	15	24
Weight (with valve) (kg)	0.071	0.087	0.104	0.081	0.105

Please complete: xx = Color ( 30 = black, 40 = red )

## 18-T-30-013 2 position switch

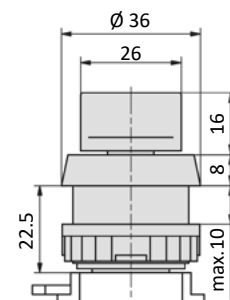

Model-no.: 18-T-30-013 +	T-25-311	T-28-311	T-28-511	T-30-310	T-30-510
Symbol					
Actuating force at 6 bar (N)	24	23	15	15	25
Weight (with valve) (kg)	0.071	0.087	0.104	0.081	0.105

# Actuator Ø 30 mm

## 18-T-30-014 Key-return

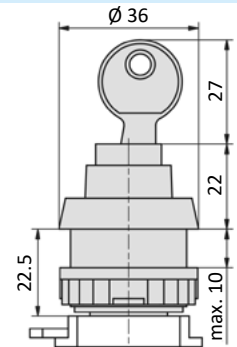

Model-no.: 18-T-30-014 +	T-25-311	T-28-311	T-28-511	T-30-310	T-30-510
Symbol					
Actuating force at 6 bar (N)	24	23	15	15	25
Weight (with valve) (kg)	0.122	0.138	0.155	0.132	0.156

## 18-T-30-016 Toggle

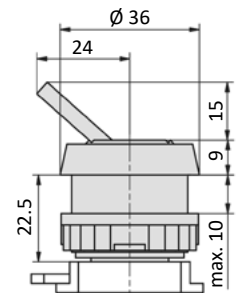

Model-no.: 18-T-30-016 +	T-25-311	T-28-311	T-28-511	T-30-310	T-30-510
Symbol					
Actuating force at 6 bar (N)	24	23	15	9	11
Weight (with valve) (kg)	0.069	0.085	0.102	0.079	0.103

## 18-T-30-018 Mushroom red, detent

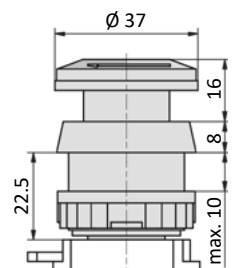

Model-no.: 18-T-30-018 +	T-25-311	T-28-311	T-28-511	T-30-310	T-30-510
Symbol					
Actuating force at 6 bar (N)	24	23	15	31	25
Weight (with valve) (kg)	0.077	0.093	0.110	0.087	0.111